

User Manual

JAXPETY

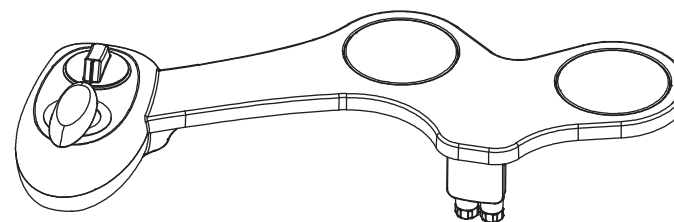

JAXPETY

You need

① 1 person is needed



WARNING! PLEASE PLACE ALL THE PRODUCTS AT ROOM TEMPERATURE AND DO NOT STORAGE THE BIDETS AND ITS ACCESSORIES IN THE FREEZING TEMPERATURE ENVIORNMENTS UNDER 0 DEGREE CELCIUS!

1. NAMES AND FUNCTIONS OF PARTS

Parts

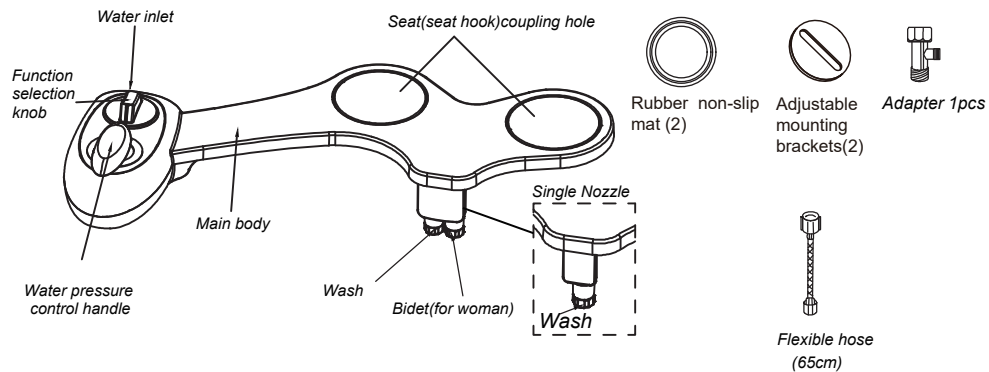

Installation Tools Needed

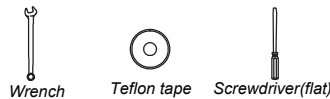

2. INSTALLATION

PREPARATION

A. Remove the existing toilet seat.

C. Flush toilet to drain tank completely.

B. Turn off the water valve.

D. Take out exiting water pipe.

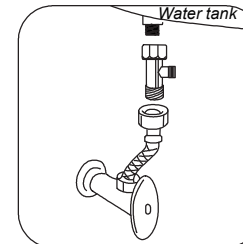

A. Install adaptor beneath water tank.

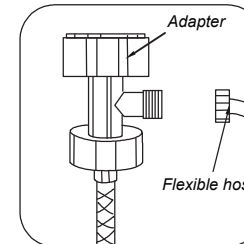

B. Connect flexible hose into adaptor.

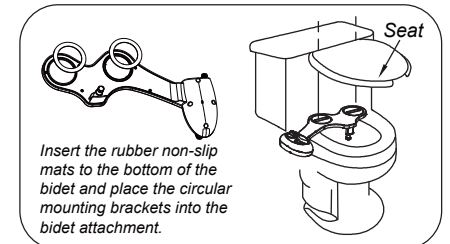

C. Install rubber non-slip mats and circular mounting brackets into bidet, and install it on toilet adjust it in suitable position



HELPFUL TIP:

Over tightening flexible hoses adaptor can cause damage to the threads and result in water leakage. Use only hand pressure first and check for any leakage. Turn only less than quarter turn at a time making sure there is no leakage.

3. FINAL ASSEMBLED FIGURE

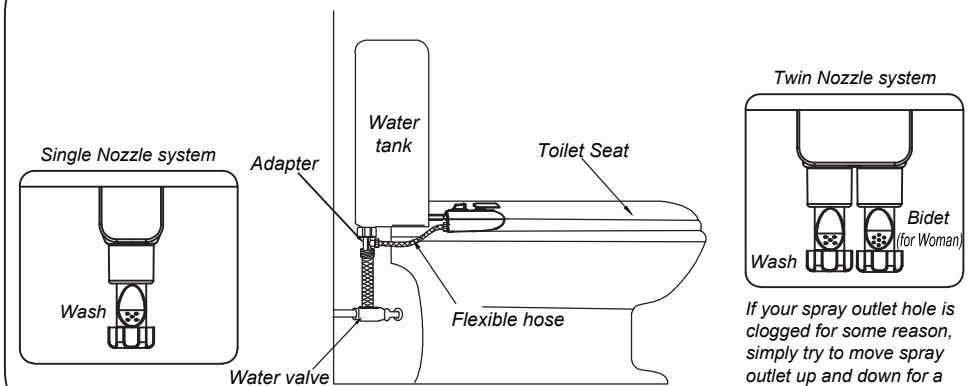

TROUBLE SHOOTING