

PRODUCT MANUAL



ATTENTION! PLEASE READ THESE INSTRUCTIONS BEFORE USING THIS DEVICE

**PRODUCT
MANUAL**



NOTICE:

If your package is missing parts or you are having issues with assembly, please call us directly. Our customer service team will address any questions or concerns you may have. Have this manual open and ready for reference.



SAFETY

To reduce risk of injury when assembling & using the chair, follow these precautions:

- Read all of these instructions before assembling and using your salon chair.
- It is helpful to have 2 people assemble and turn the chair upright after assembling.
- Do not over-extend the chair(0~150kg), creating the risk of falls or tipping the chair, and its occupant over, resulting in injury

OTHER ITEMS YOU WILL NEED (not included)

- Hand Tools:Wrench,Rubber Mallet,Screwdriver (Phillips),Sturdy box

PARTS & FEATURES

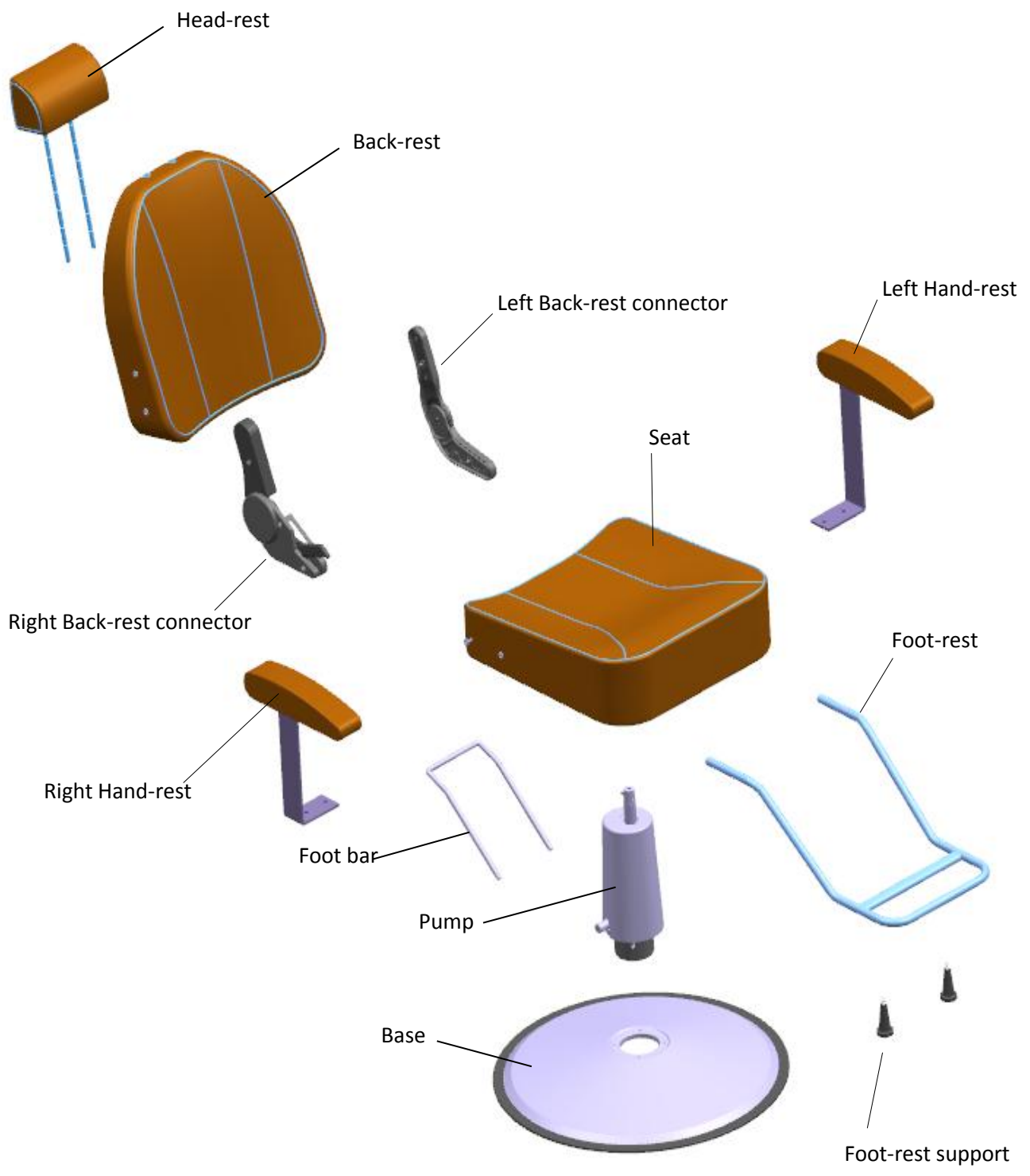

Nut of pump X4

Installation instruction

First:Install the pump to the base

Step 1 .Install the pump to the base with the 4 nuts of pump.

Please follow up the diagram beside

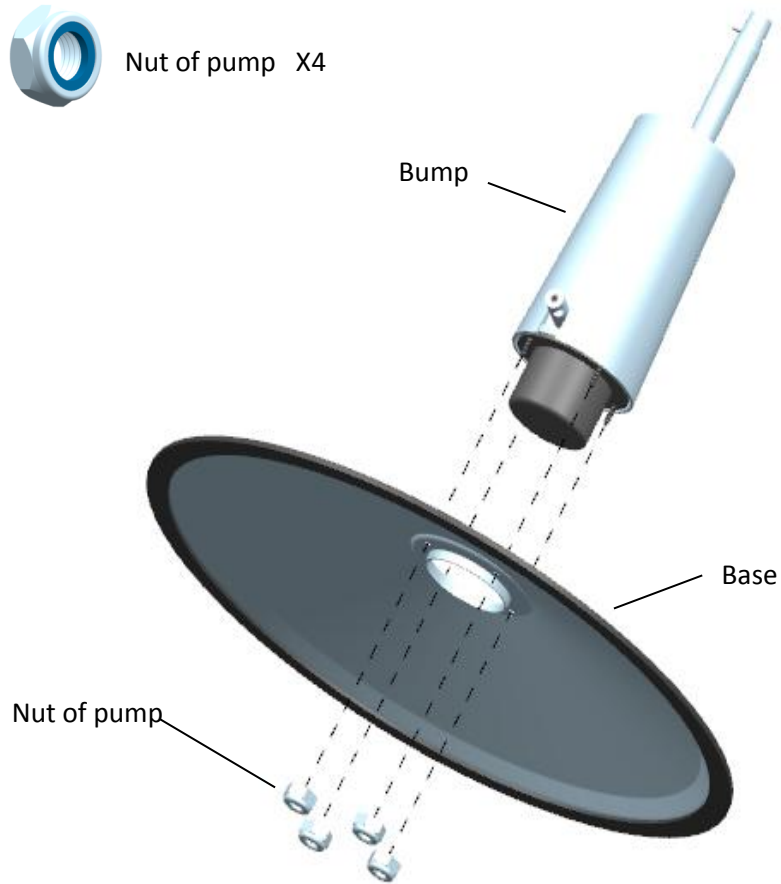

Second:Install the Foot bar to the pump

Step 1 .Loosen the 2 small set screws which pre-fixed in the pump .

Step 2 .Install the Foot bar to the pump with the 2 small set bolts .

Please follow up the diagram beside

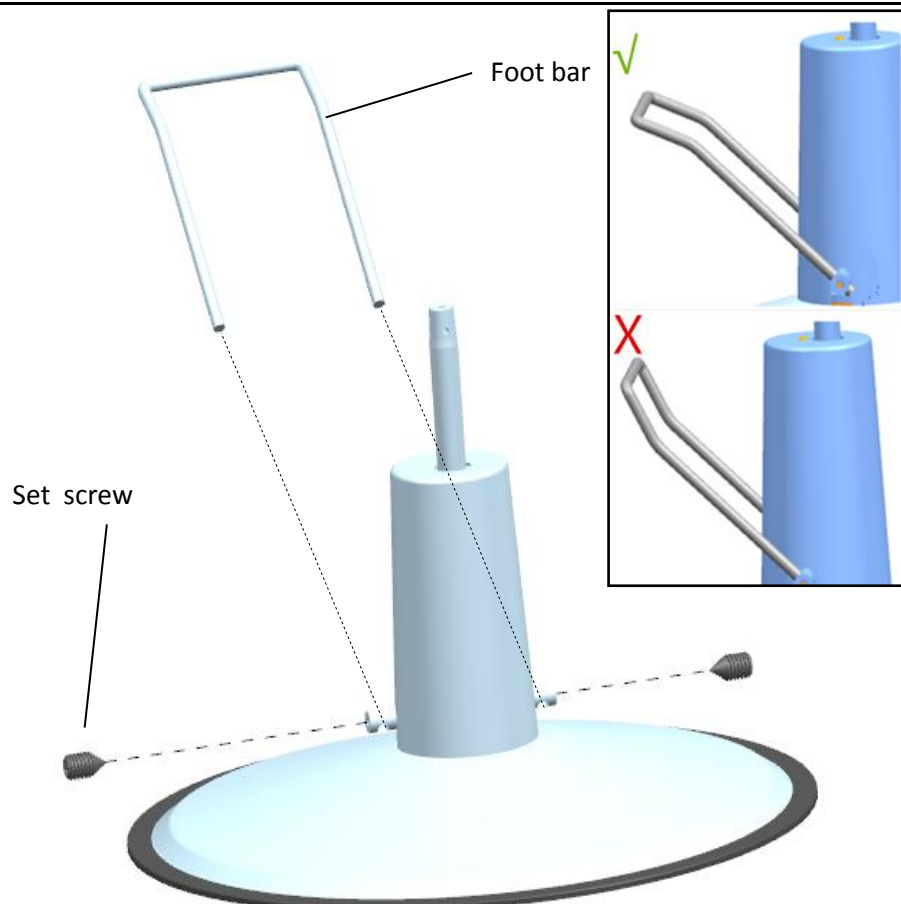

Third:Install the back-rest to the Seat

- Step 1** .Remove the 8 bolts which pre-fixed in the back-rest and the seat.
 - Step 2**.Remove the covers of the back-rest connectors .
 - Step 3**.Install the back-rest to the seat with the removed back-rest connectors and the 8 bolts .
 - Step 4** .Install the covers of the back-rest connectors to the connectors .
 - Step 5** .Insert the head-rest to the back-rest.
- Please follow up the diagram beside**

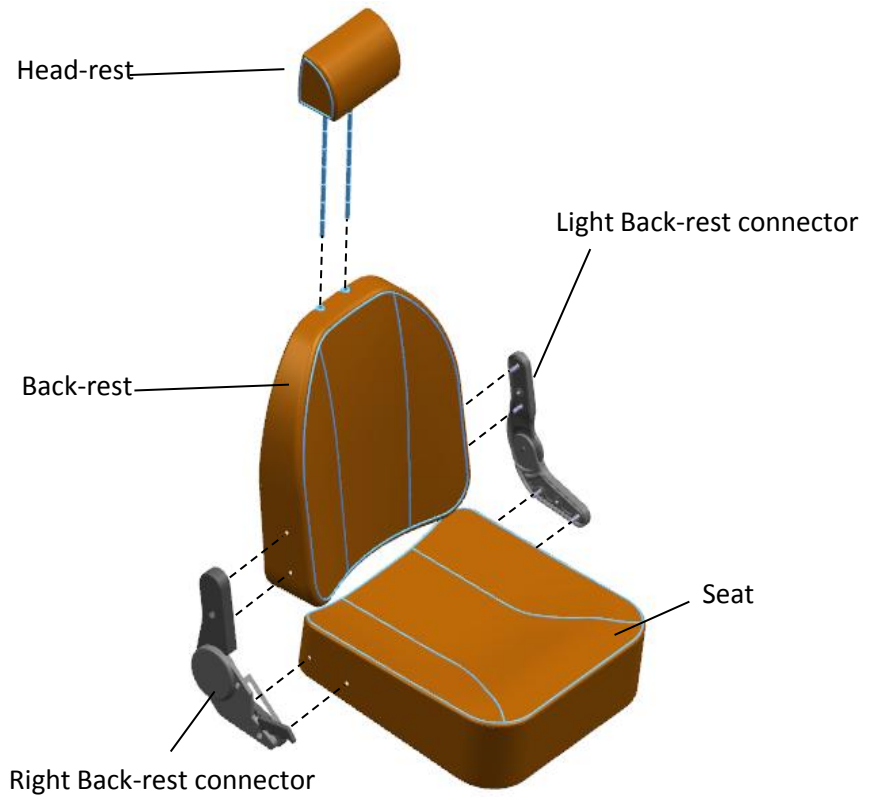

Fourth:Install the hand-rests to the Seat

- Step 1** .Remove the 4 bolts which pre-fixed in bottom of seat.
 - Step2**.Install the hand-rests to the seat by the 4 bolts .
- Please follow up the diagram beside**

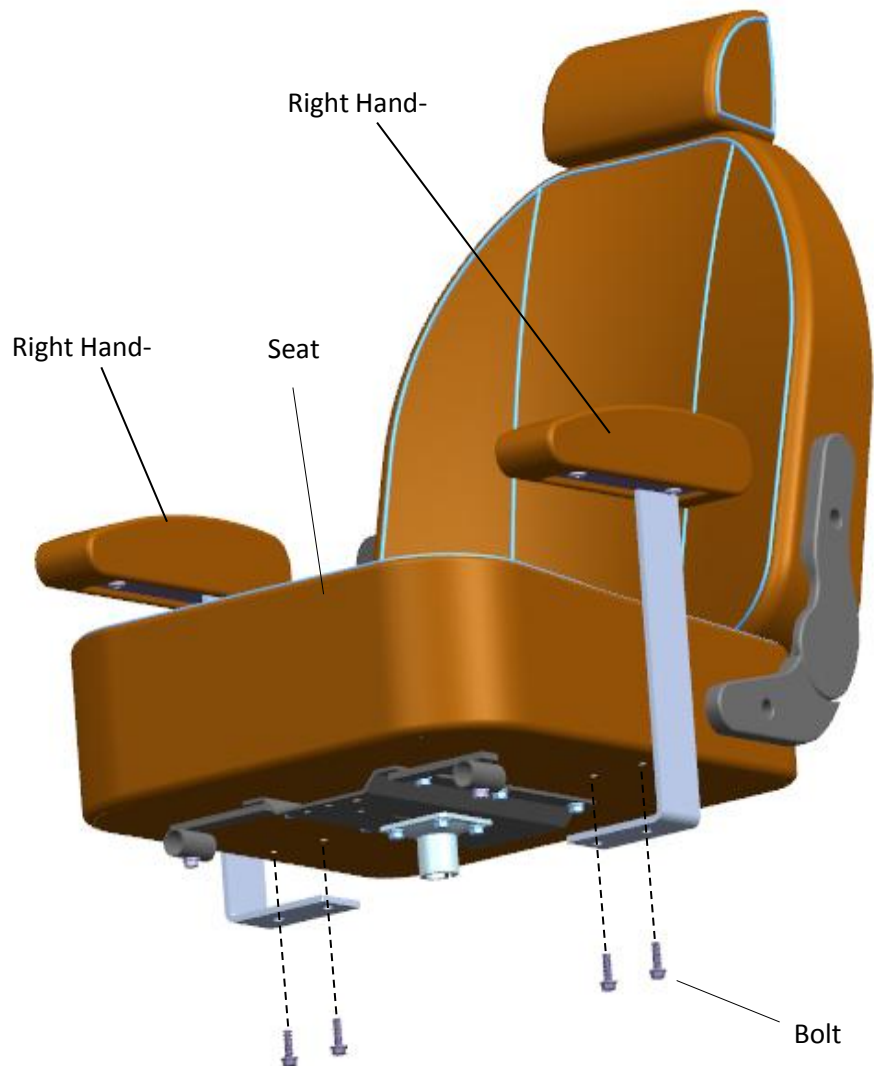

Fifth: Set the Seat onto the top of Pump

Step 1. Locate the slot in the short column under the Seat. Align this slot with the black pin at the top of pump.

Step 2. Set installed Seat & Backrest onto installed Pump & Base and press down.

Please follow up the diagram beside

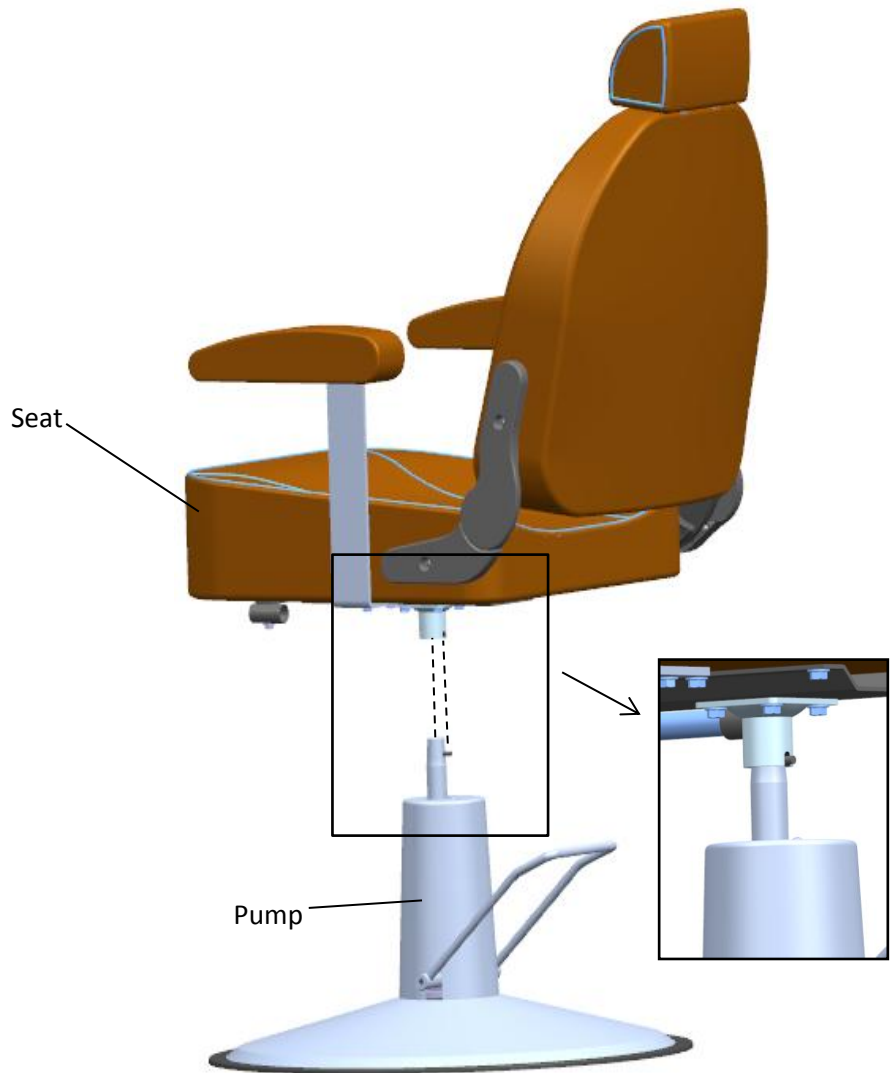

Sixth: Install the foot-res and foot-rest supports to the seat

Step 1. Install the 2 foot-rest supports to the foot-rest .

Step 2. Remove the 2 bolts which pre-fixed in the seat then Install the foot-rest to the bottom of seat by the 2 bolts .

Please follow up the diagram beside

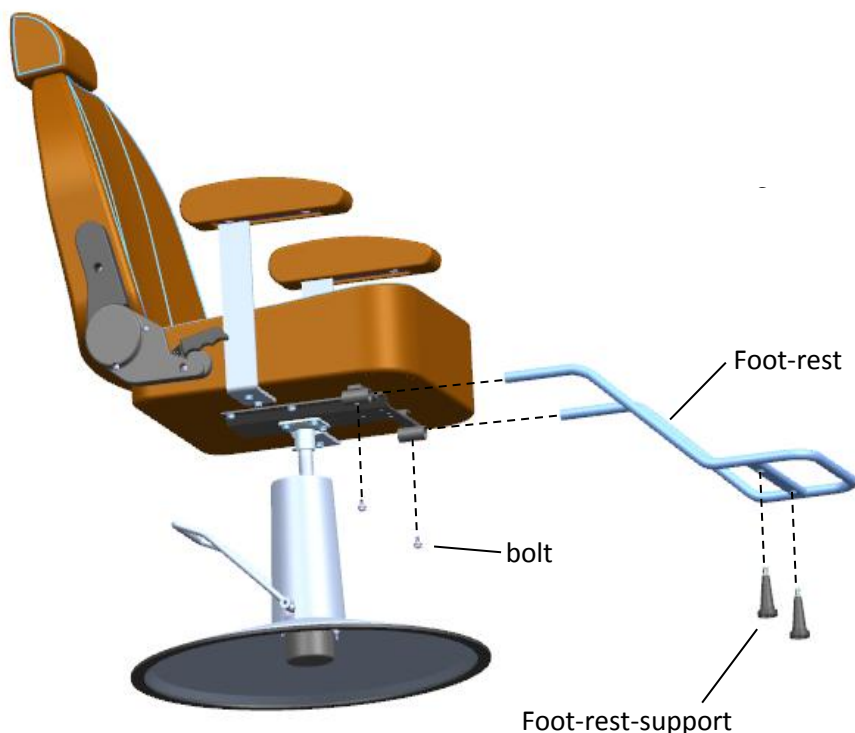

Operation the chair

First :

1. In the natural state, the upper part of the pump can rotate freely on the rotation axis of the pump;
2. Hold up the foot bar to lock the rotating .



Second : Raising the Chair

- Step down on the Foot Bar repeatedly to raise the chair to the desired height.
- Do not over-extend the chair, creating the risk of falls or tipping the chair and its occupant over, resulting in injury



Third: Lowering the Chair

- Step down and hold the Foot Bar to allow chair to lower.

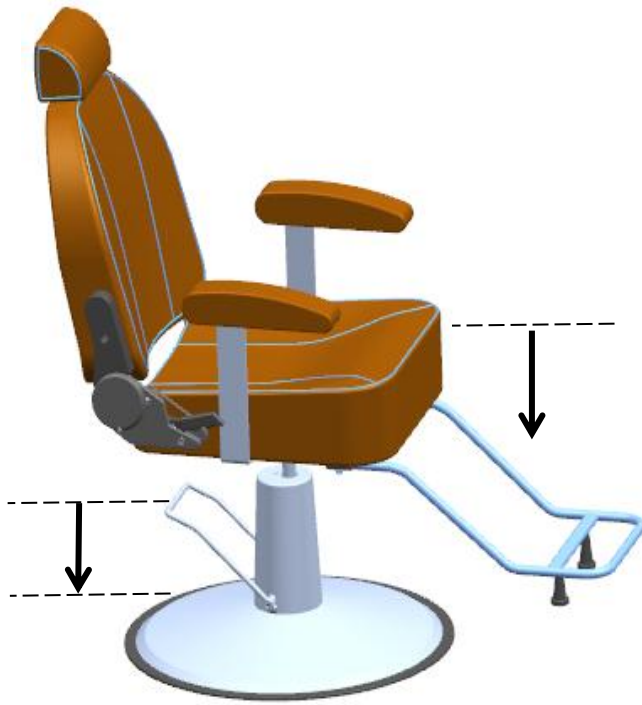

Fourth : Recline the Back-rest

- Push the lever up (15° ~ 20°) and push the back-rest to back . The back-rest will tilt backwards;loosen the lever to get the tilt degree of backrest ;Turn the lever again backwards (15° ~ 20°) ,the backrest can Back to the original position.Don't push lever too hard. It 'll break the lever.



Fifth :

Pull or insert the headrest directly by hand to adjust its height

